



# Dutra Plaza

46923 Warm Springs Blvd. ♦ Fremont, CA



## PROPERTY PROFILE

Locations	46923 Warm Springs Blvd. Fremont, CA
Space Available	
Site Size	± 0.5 Acres / ± 20,000 Sq. Ft.
APN	519-95-17
Year Built	1987
Property Zoning	CC
Parking	36

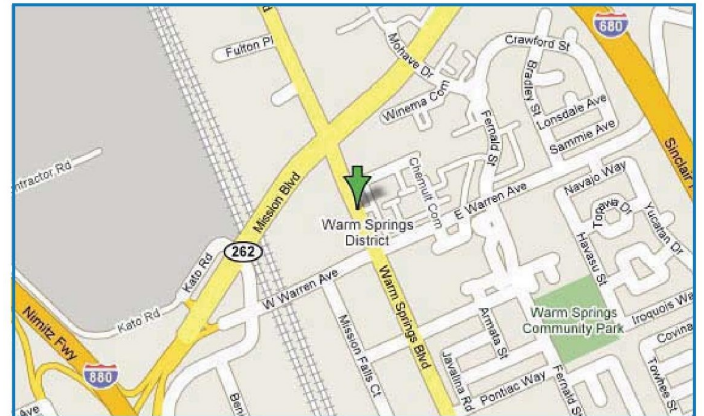

Superb, convenient location along high-traffic Warm Springs Blvd.! Two-story building with street front visibility and ample parking in the rear. Features and amenities include:

- ♦ Ideal for professional and medical office uses
- ♦ Traffic count over 88,600 Vehicles per day at Warm Springs and Mission Blvd.
- ♦ Located between I-880 and I-680 and just minutes from 237, 101 and the Silicon Valley
- ♦ Adjacent to the Little Taipei shopping plaza and Ranch 99 Supermarket
- ♦ Across from Safeway, Ross, Walgreens, banks, eateries and various condo communities



## Dutra Enterprises

INCORPORATED

For more information, please contact:

**James Wilson, Property Manager**  
(408) 898-0650

[james@dutraenterprises.com](mailto:james@dutraenterprises.com)

**Pei Liao, CFO 廖小姐**  
(510) 249-0840

[pei@dutraenterprises.com](mailto:pei@dutraenterprises.com)

**Dutra Enterprises, Inc.**  
43360 Mission Blvd. Ste#230  
Fremont, CA 94539  
[www.dutraenterprises.com](http://www.dutraenterprises.com)

# Dutra Plaza

46923 Warm Springs Blvd. ♦ Fremont, CA



## GROUND LEVEL

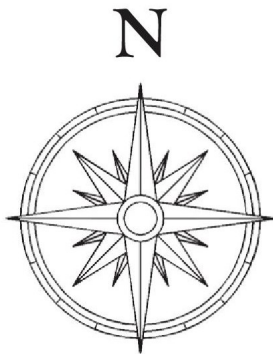

## UPPER LEVEL

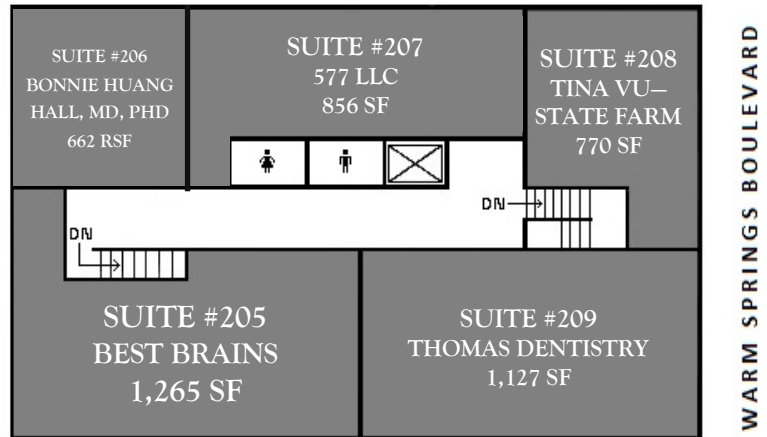
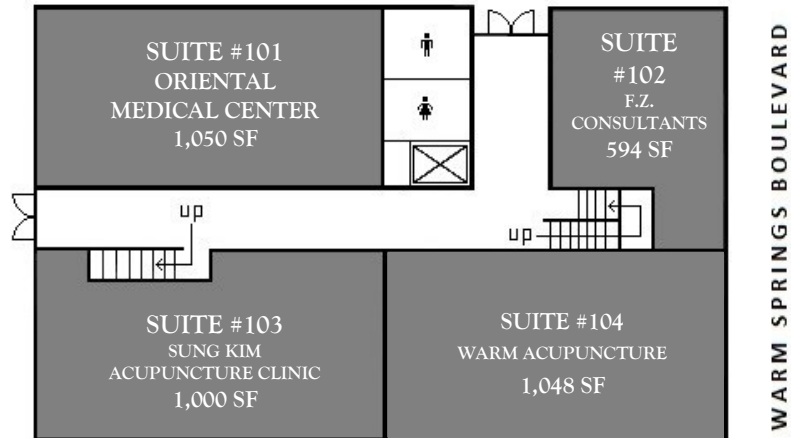

### 2007 DEMOGRAPHICS

	1-Mile:	3-Mile:
Population	604	43,445
Households	230	13,330
Average HH Income	\$74,135	\$155,655
HHs Income > \$50K	72.6%	80.5%
HHs Income > \$100K	12.6%	47.6%
Median Age	30	36
College Graduates	70.5%	55.9%

Source: Focus on Fremont



For more information, please contact:

James Wilson, Property Manager    Pei Liao, CFO 廖小姐  
 (408) 898-0650    (510) 249-0840  
[james@dutraenterprises.com](mailto:james@dutraenterprises.com)    [pei@dutraenterprises.com](mailto:pei@dutraenterprises.com)

**Dutra Enterprises, Inc.**  
 43360 Mission Blvd. Ste#230  
 Fremont, CA 94539  
[www.dutraenterprises.com](http://www.dutraenterprises.com)